



## **TG15 Spot Light**

---

### **The scope of application**

This product is designed to use for illumination in ship, dock, port and wharf, square and tunnel etc.

### **Products feature**

1. Easy to replace the bulbs.
2. The body of light is made of good quality stainless steel by compression molding with excellent corrosion resistance.
3. The shade adopt toughened glass.
4. The body of light can be adjusted about 90 degree up and 45 degree down.
5. High-pure aluminum reflector with perfect reflective effect.
6. The cable outside diameter is  $\varnothing 10\sim 14\text{mm}$ .

---

## Adopt standard and product certification

1. Conform to RULES FOR CLASSIFICATION OF SEA-GOING STEEL SHIPS.
2. Conform to GB7000.7 of SAFETY REQUIREMENTS FOR FLOOD LIGHT.
3. Conform to GD01 of GUIDELINES FOR TYPE APPROVAL TEST OF ELECTRIC AND ELECTRONIC PRODUCTS.
4. Approved by China Classification Society (CCS).

## Installation

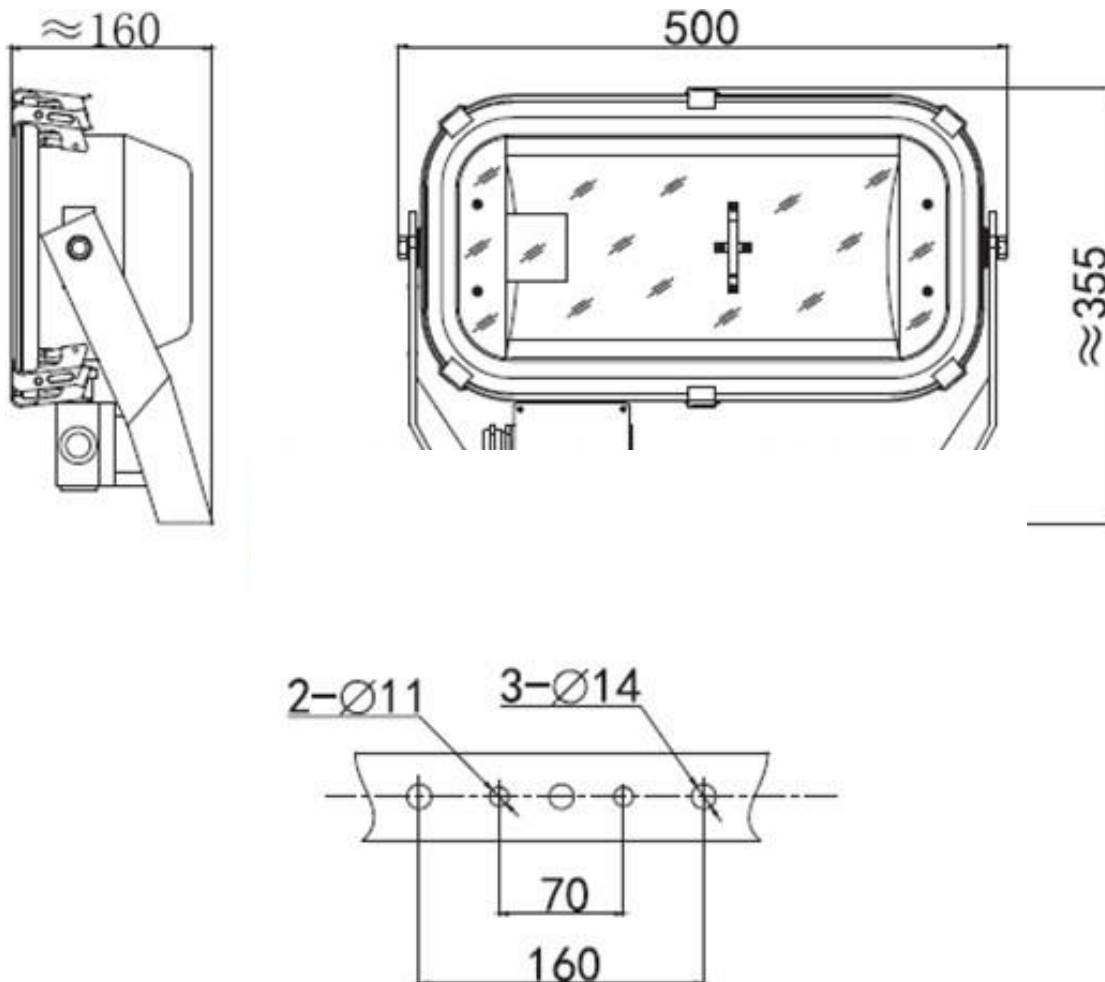

## Ballast Box

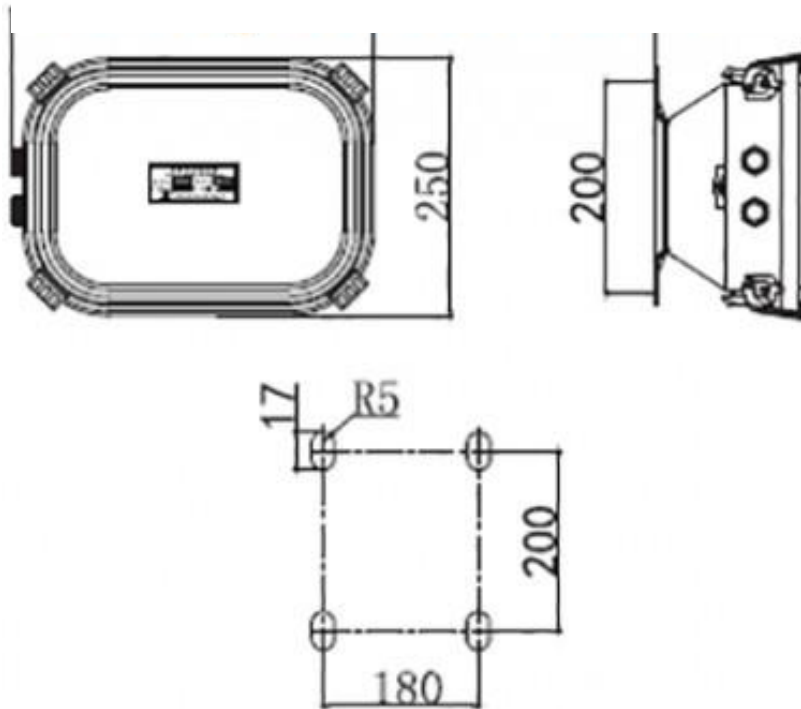

### TG15 Spot Light Specification

Type	TG15			
Voltage(V)	220V/50HZ,220V/60HZ,110V/60HZ			
Llluminant	HP Sodium Lamp		Metal Halide Lamp	
Power(W)	250W	400W	250W	400W

---

Luminous Flux(Lm)	26000	47000	20500	36000
Lamp Holder	E40			
Protection Class	IP56			
Remark	With Ballast Box			
Weight( Kg)	7.9			